

STICK SLT9 REMOTE

SLRD Remote Driver Instructions 1 of 4 Installation ou de montage

WARNING: Disconnect main power at the source prior to installation!
Fixture must be installed by a qualified electrician.

1 Mount Fixture To Wall

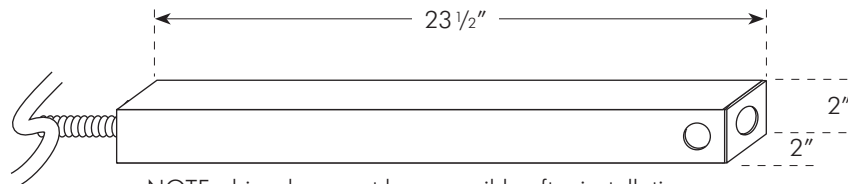

NOTE: driver box must be accessible after installation.
Lamp to driver distance must not exceed 16 ft.

25 7/16" for 3' fixture
32 3/4" for 4' fixture
43 5/8" for 6' fixture
55 3/4" for 8' fixture
center to center

Make lamp wire connections
in 2x4 box

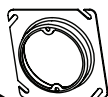
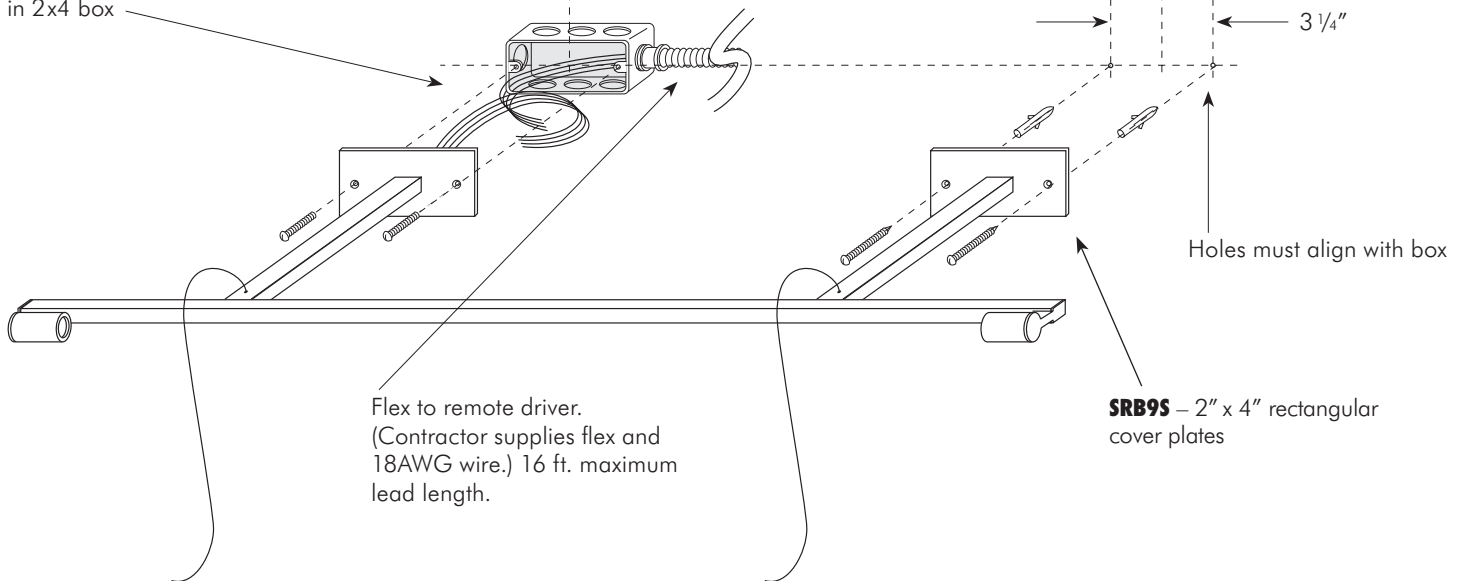

SRB9R - 4" round cover plates

NOTE: For round cover plate, mount 3-inch mud ring, screw holes vertical.

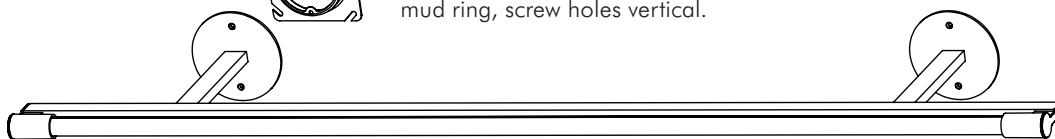

Continued →

STICK SLT9 REMOTE

SLRD Remote Driver Instructions 2 of 4 Installation ou de montage

2 Mount Cable Gripper (Not applicable to extension arms less than 10")

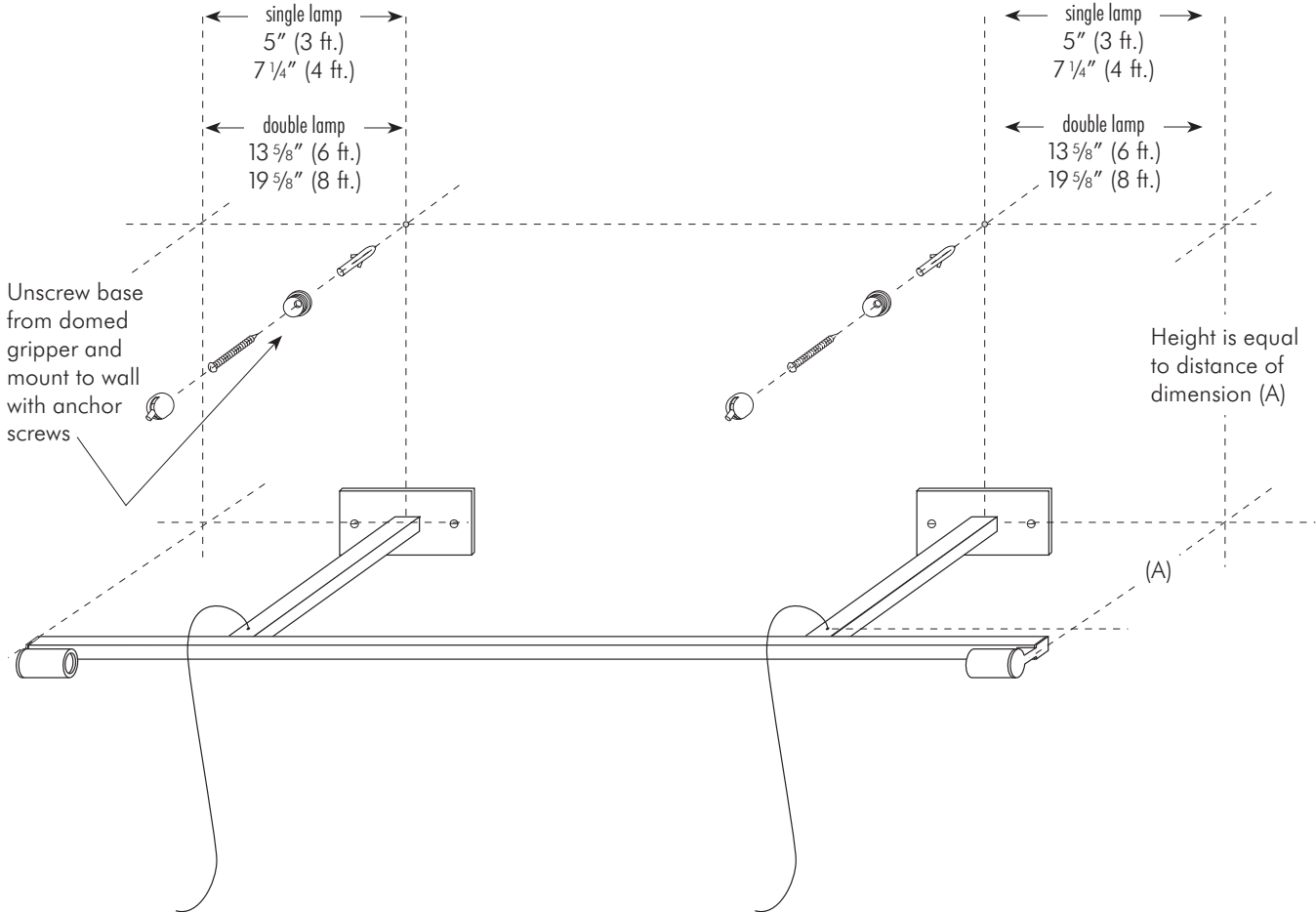

Max. Wiring Distance (at full load)

Wire Size (AWG)	Distance (ft.)
18	18
16	29
14	46
12	71
10	120

Continued →

3 Install Aircraft Cables

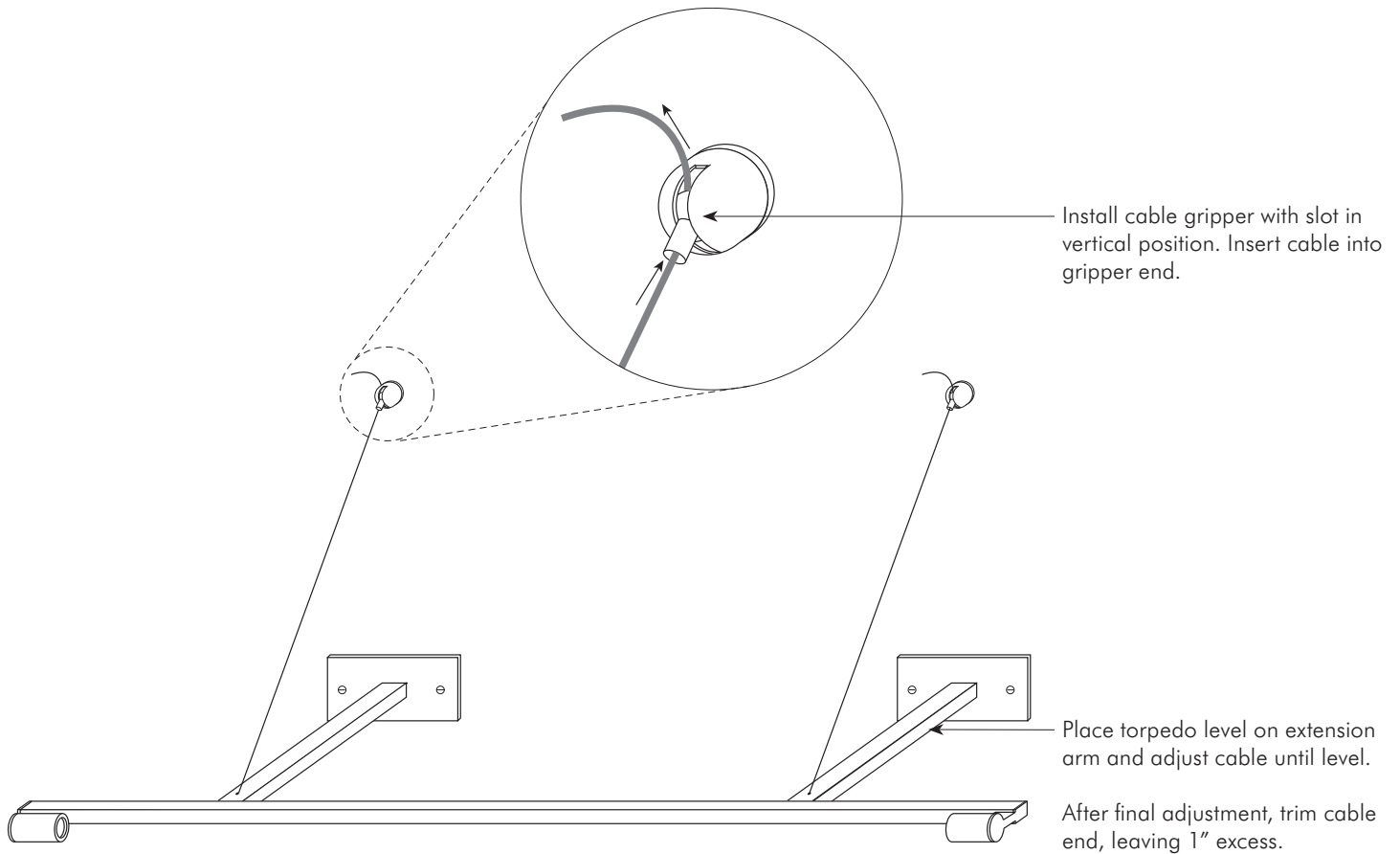

Max. Wiring Distance (at full load)

Wire Size (AWG)	Distance (ft.)
18	18
16	29
14	46
12	71
10	120

Continued →

STICK SLT9 REMOTE

SLRD Remote Driver Instructions 4 of 4 Installation ou de montage

For continuous runs of multiple fixtures:

Follow rail or remote driver installation instructions. Install right, left, and middle fixtures in correct sequence. Use slide connector to align fixtures.

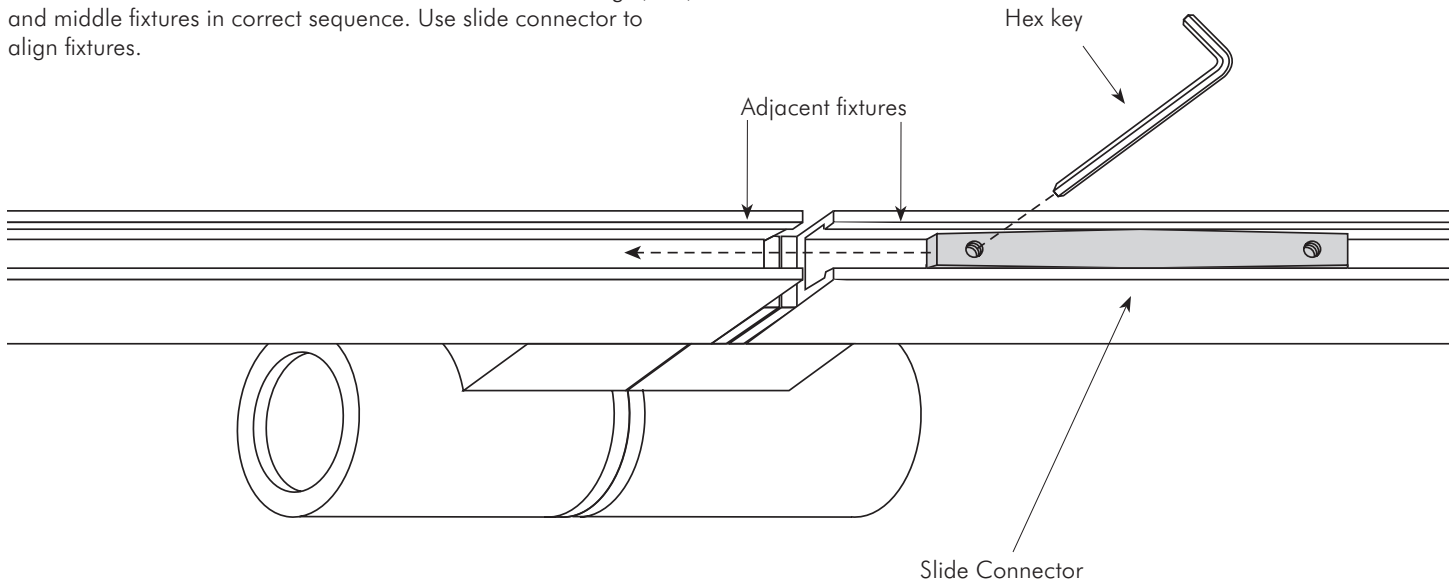

Cable Suspension:

Projections of more than 12 inches require cable support.

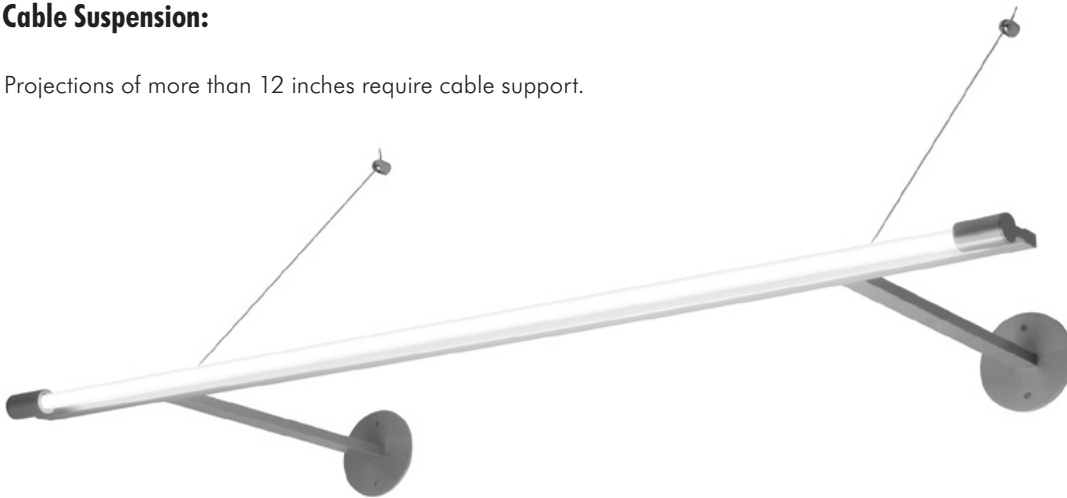

Max. Wiring Distance (at full load)

Wire Size (AWG)	Distance (ft.)
18	18
16	29
14	46
12	71
10	120