

# GU24 LED

## Conversion Kit for Recessed Lighting Installation ou de montage

**WARNING:** Risk of fire or electric shock. Install this kit only in a fixture that has the construction features shown in these installation instruction drawings.

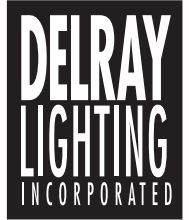

APR 2011

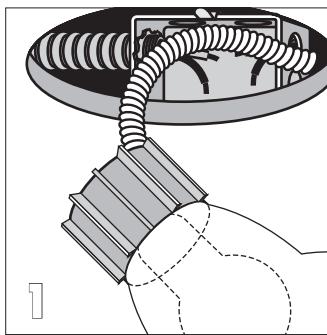
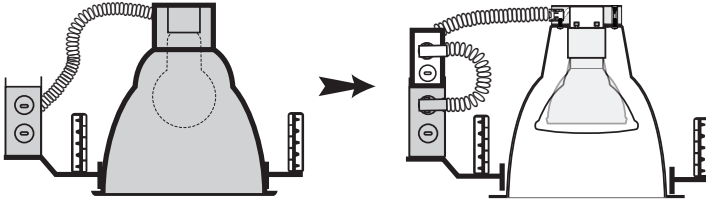

1 Pull down existing reflector from plaster frame

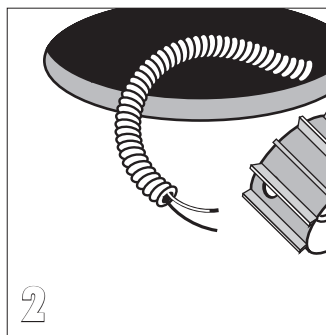

2 Carefully cut socket wires and detach power feed from socket

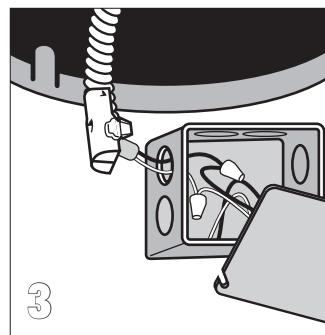

3 Attach power feed to new socket cap j-box and wire-up

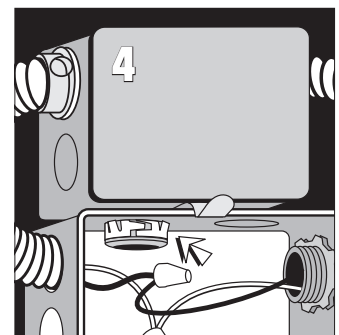

4 Connect socket j-box to existing J-box for support, use box connector

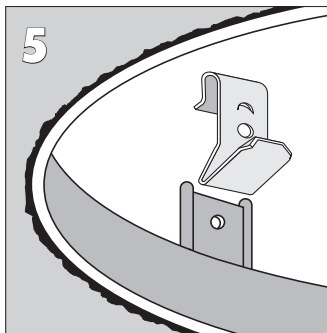

5 Snap on MC2 spring clips to mounting frame

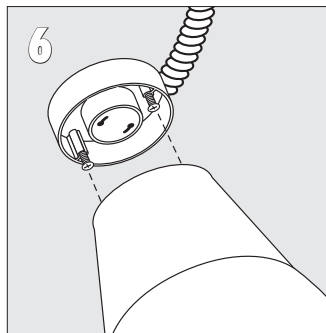

6 Attach new reflector to lamp holder by keyhole slots

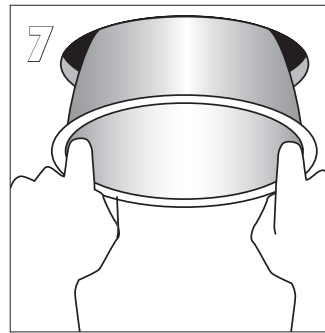

7 Slide reflector into frame, insert proper lamp and check operation

**Note:**

The existing fixture you are retrofitting may require other clip options. If you have any problem with the MC2 clip, please study the following clip options to determine the best clip.

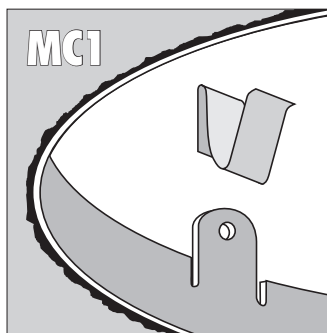

MC1 Clip snaps onto mounting frame screw holes

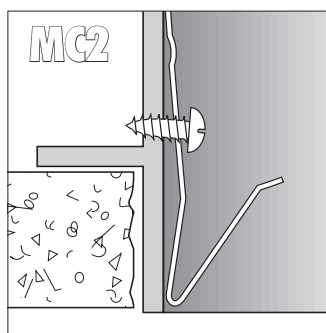

MC2 MC2 clip can be screwed into side of frame

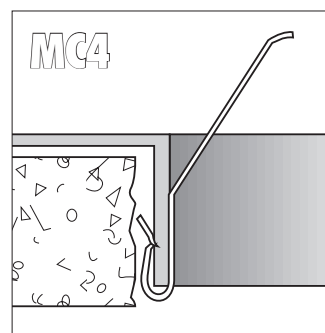

MC4 Clip mounts under mounting frame collar

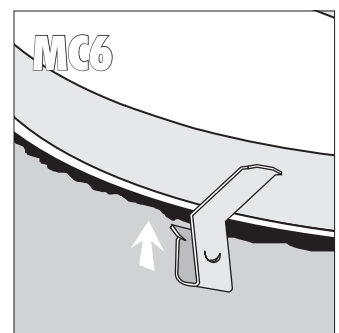

MC6 Three clips for plaster frames with thick die case aluminum collars. Clips slide up under frame.